

SMB

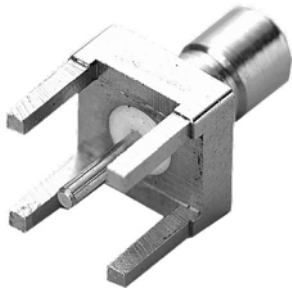

- **SMB PCB Socket**
for use with appropriate Cable Group: please specify

Unique P/N: 6300

(see Ordering Code)

SMB



- **SMB R.Ang PCB Socket**
for use with appropriate Cable Group: please specify

Unique P/N: 6301

(see Ordering Code)

SMB



- **SMB Crimp Plug**
for Cable Groups: AD/AF
contact: solder type

Unique P/N: 6303

(see Ordering Code)

SMB



- **SMB R.Ang Crimp Plug**
for Cable Groups: AD/AF
contact: solder type

Unique P/N: 6304

(see Ordering Code)

SMB



- **SMB Clamp-type Plug**
for Cable Groups: AD/AF
contact: solder type

Unique P/N: 6305

(see Ordering Code)

SMB



- **SMB R.Ang Clamp-type Cable Plug**
for Cable Groups: AD/AF
contact: solder type

Unique P/N: 6306

(see Ordering Code)

SMB



- **SMB Straight Crimp Socket**

Unique P/N: 6307

(see Ordering Code)

SMB



- **SMB Bulkhead Mount Crimp Socket**

Unique P/N: 6308

(see Ordering Code)

SMB



- **SMB Right Angle Crimp Socket**

Unique P/N: 6309

(see Ordering Code)

SMB



- **SMB Straight PCB Plug**

Unique P/N: 6310

(see Ordering Code)

SMB



- **SMB Right Angle PCB Plug**

Unique P/N: 6311

(see Ordering Code)

SMB



- **SMB Straight PCB SMT Socket**

Unique P/N: 6312

(see Ordering Code)

SMB



- **SMB Straight Solder Bulkhead Socket Front Mount**

Unique P/N: 6313

(see Ordering Code)

SMB



- **SMB Straight Solder Bulkhead Socket Rear Mount**

Unique P/N: 6314

(see Ordering Code)